

RESOLUTION NO. 17-13

**AMENDED RESOLUTION EXPANDING RURAL SPECIAL
IMPROVEMENT MAINTENANCE DISTRICT #698M
(SIERRA ESTATES SUBDIVISION)**

WHEREAS, pursuant to §7-12-2161(4), MCA, the Commissioners have the power of changing, by resolution, the boundaries of any maintenance district not more than once a year; and

WHEREAS the boundaries of RSID 698M have not been changed within the last year; and

WHEREAS, it has been determined that properties adjacent to the existing Rural Special Improvement District #698M boundaries are benefited properties accessing the district roads; and

WHEREAS, the benefited property status requires the expansion of boundaries for RSID 698M for the maintenance, preservation and repair of curb, gutter and road located within the district boundaries; and

WHEREAS, the boundaries of the district will be expanded to Block 4, Lot 12, inclusive, of Sierra Estates Subdivision and Lots 1-14, inclusive, of Aspen Ridge 2nd Filing in Yellowstone County, Montana, described in Exhibit B; and

WHEREAS, lots to be added to the district and boundaries of the expanded district are shown in Exhibit A (map).

NOW, THEREFORE, BE IT RESOLVED by the Board of County Commissioners of Yellowstone County, Montana, deeming the public interest or convenience require, intends to expand the following described Rural Special Improvement Maintenance District:

1. **DESCRIPTION OF IMPROVEMENTS, DESCRIPTION OF MAINTENANCE, METHOD OF ASSESSMENT AND ESTIMATED COSTS.** Assessments collected on behalf of this district shall be used for the maintenance, preservation, and repair of curb, gutter and road located within the boundaries of this district. All of the costs of the district shall be assessed equally on a per lot method for existing and future lots. Assessments will be established annually by the Board of County Commissioners and are subject to adjustment due to cost fluctuations related to maintenance utilization levels and changes in material and labor costs of performing necessary maintenance.
2. **DURATION.** The district shall be deemed to be perpetual in nature unless absorbed and replaced by another district or municipality.

Page 2
Resolution Expanding
RSID #698M

PASSED AND ADOPTED by the Board of County Commissioners of Yellowstone
County, Montana, this 14th day of March, 2017.

BOARD OF COUNTY COMMISSIONERS
YELLOWSTONE COUNTY, MONTANA

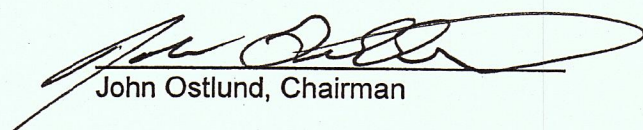
John Ostlund, Chairman

Robyn Driscoll, Member

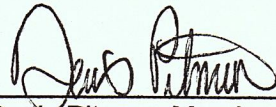
Denis Pitman, Member

(SEAL)
ATTEST:



Jeff Martin, Clerk & Recorder
Yellowstone County, Montana

EXHIBIT A

**RSID 698M &
New Proposed Boundary**

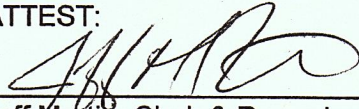
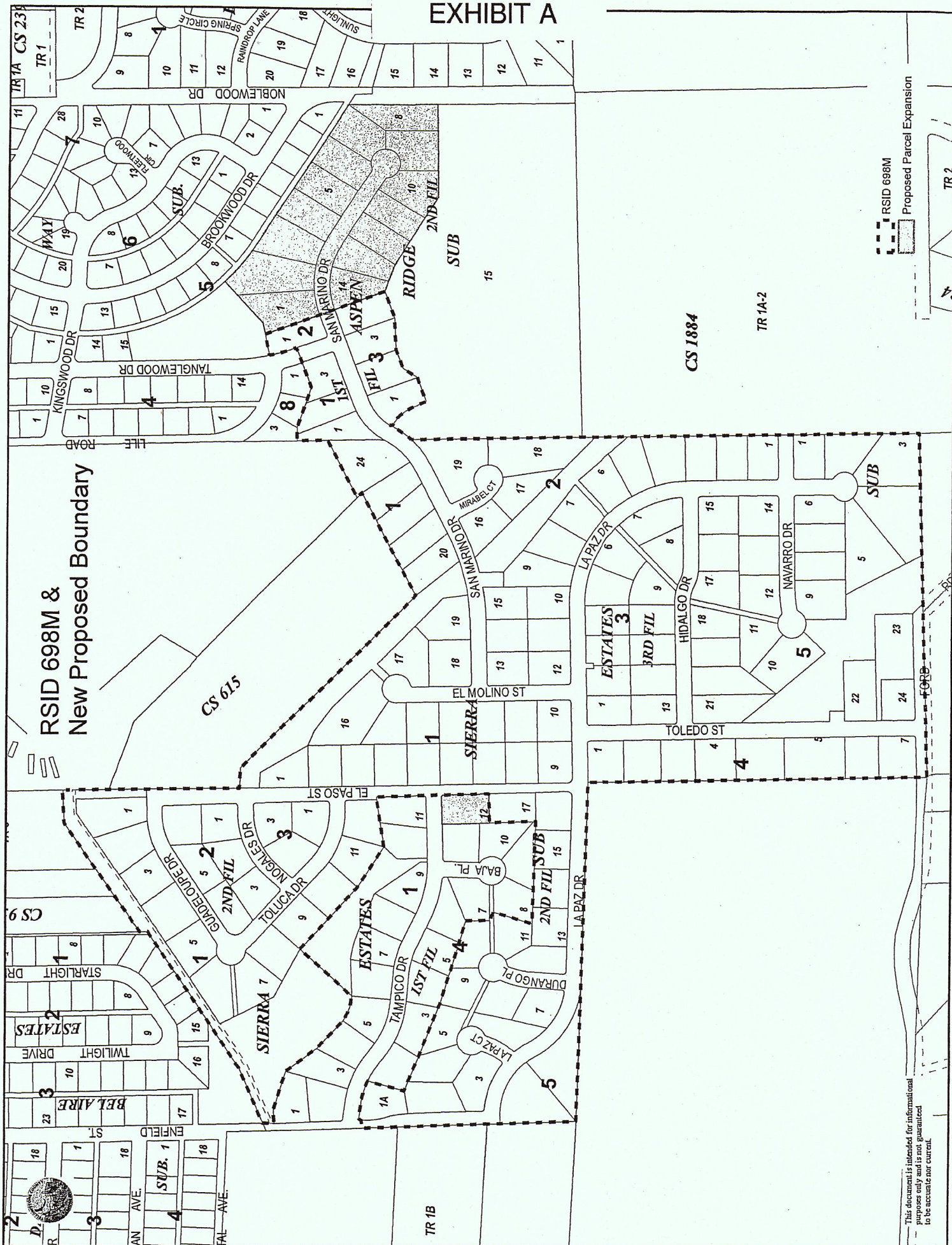

This document is intended for informational purposes only and is not guaranteed to be accurate or current.

EXHIBIT B
RSID 698M SIERRA ESTATES SUB - 2ND FILING
2016 EXPANSION

Tax ID	Assessment per Unit	Owner	Address	Legal Description
1	C14499 \$	BUSHMAN, PETER G & BOBBI J	3165 GUADELOUPE DR	SIERRA ESTATES SUB SECOND FILING, S30, T01 N, R27 E, BLOCK 1, Lot 2, 26,684 SF*
2	C14500 \$	RENNICH, DAVID A & HEATHER J	3125 GUADELOUPE DR	SIERRA ESTATES SUB SECOND FILING, S30, T01 N, R27 E, BLOCK 1, Lot 3, 24,583 SF*
3	C14501 \$	ALLEN, BRIAN C & DAYLENE K	3105 GUADELOUPE DR	SIERRA ESTATES SUB SECOND FILING, S30, T01 N, R27 E, BLOCK 1, Lot 4, 27,424 SF(*
4	C14502 \$	FORD, RONALD G & LOIS E	3075 GUADELOUPE DR	SIERRA ESTATES SUB SECOND FILING, S30, T01 N, R27 E, BLOCK 1, Lot 5, 24,693 SF(*
5	C14503 \$	POTTER, THOMAS K & JENNIFER M	3055 GUADELOUPE DR	SIERRA ESTATES SUB SECOND FILING, S30, T01 N, R27 E, BLOCK 1, Lot 6, (04)
6	C14504 \$	TROUTT, JUSTIN M & ANGELA M	590 TOLUCA DR	SIERRA ESTATES SUB SECOND FILING, S30, T01 N, R27 E, BLOCK 1, Lot 7, 25,443 SF*
7	C14505 \$	WHEELER, WENDY M &	580 TOLUCA DR	SIERRA ESTATES SUB SECOND FILING, S30, T01 N, R27 E, BLOCK 1, Lot 8, 22,946 SF*
8	C14506 \$	SUCIETTO, JAMES A & REBECCA L	570 TOLUCA DR	SIERRA ESTATES SUB SECOND FILING, S30, T01 N, R27 E, BLOCK 1, Lot 9, 23,430 SF*
9	C14507 \$	STEWART, BRETT A & MARIA L	560 TOLUCA DR	SIERRA ESTATES SUB SECOND FILING, S30, T01 N, R27 E, BLOCK 1, Lot 10, 23,411 SF*
10	C14508 \$	SYLVESTER, TARA L	550 TOLUCA DR	SIERRA ESTATES SUB SECOND FILING, S30, T01 N, R27 E, BLOCK 1, Lot 11, (04)
11	C14509 \$	SILVERNAGEL, KELLY J	530 EL PASO ST	SIERRA ESTATES SUB SECOND FILING, S30, T01 N, R27 E, BLOCK 1, Lot 12, 21,388 SF*
12	C14510 \$	LAWRENCE, FRANK W & ISABEL R	3175 NOGALES DR	SIERRA ESTATES SUB SECOND FILING, S30, T01 N, R27 E, BLOCK 1, Lot 13, 20,468 SF*
13	C14511 \$	ELLIS, J SCOTT	3165 NOGALES DR	SIERRA ESTATES SUB SECOND FILING, S30, T01 N, R27 E, BLOCK 2, Lot 1, 20,292 SF*
14	C14512 \$	GAZLEY, DANIEL	575 TOLUCA DR	SIERRA ESTATES SUB SECOND FILING, S30, T01 N, R27 E, BLOCK 2, Lot 2, 20,267 SF*
15	C14513 \$	SKINNER, LUCAS & STEPHANIE	585 TOLUCA DR	SIERRA ESTATES SUB SECOND FILING, S30, T01 N, R27 E, BLOCK 2, Lot 3, 20,267 SF*
16	C14514 \$	MCCULLOUGH, JOSEPH W & SANDRA K	3120 GUADELOUPE DR	SIERRA ESTATES SUB SECOND FILING, S30, T01 N, R27 E, BLOCK 2, Lot 4, 20,447 SF*
17	C14515 \$	JOINES, CAMERON & REBECCA	620 EL PASO ST	SIERRA ESTATES SUB SECOND FILING, S30, T01 N, R27 E, BLOCK 2, Lot 5, 20,602 SF*
18	C14516 \$	BRYANT, GREGORY PAUL & SARAH A	550 EL PASO ST	SIERRA ESTATES SUB SECOND FILING, S30, T01 N, R27 E, BLOCK 2, Lot 6, 21,775 SF*
19	C14517 \$	MARTIN, JOSEPH & JENNIFER	555 TOLUCA DR	SIERRA ESTATES SUB SECOND FILING, S30, T01 N, R27 E, BLOCK 3, Lot 1, 20,010 SF*
20	C14518 \$	ROBINSON, DAVID P & LISA M	3170 NOGALES DR	SIERRA ESTATES SUB SECOND FILING, S30, T01 N, R27 E, BLOCK 3, Lot 2, 20,115 SF*
21	C14519 \$	METTLER, MATTHEW J	515 ENFIELD ST	SIERRA ESTATES SUB SECOND FILING, S30, T01 N, R27 E, BLOCK 3, Lot 3, (04)
22	C14520 \$	KEELER, CURTIS R & JULIE A	490 LA PAZ CT	SIERRA ESTATES SUB SECOND FILING, S30, T01 N, R27 E, BLOCK 4, Lot 1, 20,284 SF*
23	C14521 \$	FLOW, PAUL R & BRENDA K	500 LA PAZ CT	SIERRA ESTATES SUB SECOND FILING, S30, T01 N, R27 E, BLOCK 4, Lot 2, (04)
24	C14522 \$	SMITH, LORI A	505 LA PAZ CT	SIERRA ESTATES SUB SECOND FILING, S30, T01 N, R27 E, BLOCK 4, Lot 3, 26,415 SF*
25	C14523 \$	HEIM, EUGENE H & LINDA G	485 LA PAZ CT	SIERRA ESTATES SUB SECOND FILING, S30, T01 N, R27 E, BLOCK 4, Lot 4, (04)
26	C14524 \$	HANSEN, KRISTINA J & KENDAL C	410 DURANGO PL	SIERRA ESTATES SUB SECOND FILING, S30, T01 N, R27 E, BLOCK 4, Lot 5, 20,006 SF*
27	C14525 \$	NELSON, LOREN D	420 DURANGO PL	SIERRA ESTATES SUB SECOND FILING, S30, T01 N, R27 E, BLOCK 4, Lot 6, 20,859 SF*
28	C14526 \$	SCHANTZ, DAVID A & SARA E	430 DURANGO PL	SIERRA ESTATES SUB SECOND FILING, S30, T01 N, R27 E, BLOCK 4, Lot 7, (04)
29	C14527 \$	JONES, RONALD R & CINDY A	435 DURANGO PL	SIERRA ESTATES SUB SECOND FILING, S30, T01 N, R27 E, BLOCK 4, Lot 8, 20,024 SF*
30	C14528 \$	MCTEE, KEVIN E	425 DURANGO PL	SIERRA ESTATES SUB SECOND FILING, S30, T01 N, R27 E, BLOCK 4, Lot 9, (04)
31	C14529 \$	GEIS, ANDREW E & ASHLEY	3085 LA PAZ DR	SIERRA ESTATES SUB SECOND FILING, S30, T01 N, R27 E, BLOCK 4, Lot 10, 20,044 SF*
32	C14530 \$	VOGES, CHARLES W & RONNA M	3105 LA PAZ DR	SIERRA ESTATES SUB SECOND FILING, S30, T01 N, R27 E, BLOCK 4, Lot 11, 20,039 SF*
33	C14531 \$	MONACO, DANIEL J & PAMELA C	3125 LA PAZ DR	SIERRA ESTATES SUB SECOND FILING, S30, T01 N, R27 E, BLOCK 4, Lot 12, 20,039 SF*
34	C14532 \$	VASKY, JAMES W &	3145 LA PAZ DR	SIERRA ESTATES SUB SECOND FILING, S30, T01 N, R27 E, BLOCK 4, Lot 13, 20,038 SF*
35	C14533 \$	STEWART, GEORGE B & JUDY A	480 EL PASO ST	SIERRA ESTATES SUB SECOND FILING, S30, T01 N, R27 E, BLOCK 4, Lot 14, (04)
36	C14534 \$	UDELHOVEN, LARRY C & DEBRA L	490 EL PASO ST	SIERRA ESTATES SUB SECOND FILING, S30, T01 N, R27 E, BLOCK 4, Lot 15, 20,038 SF*
37	C14535 \$	MARQUESS, RICHARD & KRISTIE	3040 LA PAZ DR	SIERRA ESTATES SUB SECOND FILING, S30, T01 N, R27 E, BLOCK 4, Lot 16, 20,038 SF*
38	C14536 \$	FOUNTAIN, ROBERT L	3000 LA PAZ DR	SIERRA ESTATES SUB SECOND FILING, S30, T01 N, R27 E, BLOCK 5, Lot 1, (04)
39	C14537 \$	WATSON, J DELBERT & DEBORAH S	3185 GUADELOUPE DR	SIERRA ESTATES SUB SECOND FILING, S30, T01 N, R27 E, BLOCK 5, Lot 2, (04)
40	C14542 \$	KNELS, LARRY R	555 EL PASO ST	SIERRA ESTATES SUB 3RD FIL, S29, T01 N, R27 E, BLOCK 1, Lot 1, 32,125 SF*
41	C15499 \$	TAYLOR, CORRY	545 EL PASO ST	SIERRA ESTATES SUB 3RD FIL, S29, T01 N, R27 E, BLOCK 1, Lot 1, 20,044 SQ FT (07)
42	C15500 \$	JENSEN, BRETT & JUNE	535 EL PASO ST	SIERRA ESTATES SUB 3RD FIL, S29, T01 N, R27 E, BLOCK 1, Lot 2, 20,000 SQ FT (07)
43	C15501 \$	FRESE, BRADLEY S & STEFENI F	525 EL PASO ST	SIERRA ESTATES SUB 3RD FIL, S29, T01 N, R27 E, BLOCK 1, Lot 3, 20,000 SQ FT (07)
44	C15502 \$	ROLLINS, MICHAEL S & LACEY L	515 EL PASO ST	SIERRA ESTATES SUB 3RD FIL, S29, T01 N, R27 E, BLOCK 1, Lot 4, 20,000 SQ FT (*)
45	C15503 \$	TALMARK, NICHOLAS JEREMI & LINDSEY K	505 EL PASO ST	SIERRA ESTATES SUB 3RD FIL, S29, T01 N, R27 E, BLOCK 1, Lot 5, 20,000 SQ FT (*)
46	C15504 \$	NATIONS, BRICE L & JESSICA MARIE	495 EL PASO ST	SIERRA ESTATES SUB 3RD FIL, S29, T01 N, R27 E, BLOCK 1, Lot 6, 20,000 SQ FT (*)
47	C15505 \$	COOK, MILAN A & LUANN M	485 EL PASO ST	SIERRA ESTATES SUB 3RD FIL, S29, T01 N, R27 E, BLOCK 1, Lot 7, 20,000 SQ FT (0*)
48	C15506 \$	SPITZER, DONALD L	3225 LA PAZ DR	SIERRA ESTATES SUB 3RD FIL, S29, T01 N, R27 E, BLOCK 1, Lot 8, 20,000 SQ FT (*)
49	C15507 \$	FISCHER, THOMAS C JR	3235 LA PAZ DR	SIERRA ESTATES SUB 3RD FIL, S29, T01 N, R27 E, BLOCK 1, Lot 9, 20,713 SQ FT (07)
50	C15508 \$	WENTZELL, JOE	420 EL MOLINO ST	SIERRA ESTATES SUB 3RD FIL, S29, T01 N, R27 E, BLOCK 1, Lot 10, 20,779 SQ FT (*)
51	C15509 \$	MIZELLE, NICHOLAS JR & DEBORAH	450 EL MOLINO ST	SIERRA ESTATES SUB 3RD FIL, S29, T01 N, R27 E, BLOCK 1, Lot 11, 20,000 SQ FT (*)
52	C15510 \$	BRANDEL, JEREMY D & LYNETTE L	480 EL MOLINO ST	SIERRA ESTATES SUB 3RD FIL, S29, T01 N, R27 E, BLOCK 1, Lot 12, 20,000 SQ FT (0*)
53	C15511 \$	KREBS, JOHN M &	500 EL MOLINO ST	SIERRA ESTATES SUB 3RD FIL, S29, T01 N, R27 E, BLOCK 1, Lot 13, 20,000 SQ FT (*)
54	C15512 \$			SIERRA ESTATES SUB 3RD FIL, S29, T01 N, R27 E, BLOCK 1, Lot 14, 20,000 SQ FT (0*)

EXHIBIT B

RSID 698M SIERRA ESTATES SUB - 2ND FILING
2016 EXPANSION

55	C15513	\$	150.00	FANDRICH, BRYAN & JAMIE	520 EL MOLINO ST	SIERRA ESTATES SUB 3RD FIL, S29, T01 N, R27 E, BLOCK 1, Lot 15, 20000 SQ FT	(0*
56	C15514	\$	150.00	FANDRICH, BRYAN & JAMIE	540 EL MOLINO ST	SIERRA ESTATES SUB 3RD FIL, S29, T01 N, R27 E, BLOCK 1, Lot 16, 46370 SQ FT	(0*
57	C15515	\$	150.00	MOSHER, JASON A	505 EL MOLINO ST	SIERRA ESTATES SUB 3RD FIL, S29, T01 N, R27 E, BLOCK 1, Lot 17, 27877 SQ FT	(0*
58	C15516	\$	150.00	FROST, TRAVUS C & GINA R	3265 SAN MARINO DR	SIERRA ESTATES SUB 3RD FIL, S29, T01 N, R27 E, BLOCK 1, Lot 18, 28779 SQ FT	(0*
59	C15517	\$	150.00	BECKER, DANIEL JR	3285 SAN MARINO DR	SIERRA ESTATES SUB 3RD FIL, S29, T01 N, R27 E, BLOCK 1, Lot 19, 26924 SQ FT	(07)
60	C15518	\$	150.00	CRANE, CHRISTOPHER &	3325 SAN MARINO DR	SIERRA ESTATES SUB 3RD FIL, S29, T01 N, R27 E, BLOCK 1, Lot 20, 24794 SQ FT	(0*
61	C15519	\$	150.00	ROBINSON, NICKOLAS N &	3335 SAN MARINO DR	SIERRA ESTATES SUB 3RD FIL, S29, T01 N, R27 E, BLOCK 1, Lot 21, 23459 SQ FT	(0*
62	C15520	\$	150.00	AILES, JETTON L & KYLE H	3345 SAN MARINO DR	SIERRA ESTATES SUB 3RD FIL, S29, T01 N, R27 E, BLOCK 1, Lot 22, 23544 SQ FT	(0*
63	C15521	\$	150.00	CRITCHLOW, NATALIE & BRIAN	3355 SAN MARINO DR	SIERRA ESTATES SUB 3RD FIL, S29, T01 N, R27 E, BLOCK 1, Lot 23, 23426 SQ FT	(0*
64	C15522	\$	150.00	CHELGRE, GARY T & JACKIE R	3365 SAN MARINO DR	SIERRA ESTATES SUB 3RD FIL, S29, T01 N, R27 E, BLOCK 1, Lot 24, 38539 SQ FT	(0*
65	C15524	\$	150.00	KENMARK CORPORATION	3425 LA PAZ DR	SIERRA ESTATES SUB 3RD FIL, S29, T01 N, R27 E, BLOCK 2, Lot 1, 20327 SQ FT	(0*
66	C15525	\$	150.00	KENMARK CORPORATION	3405 LA PAZ DR	SIERRA ESTATES SUB 3RD FIL, S29, T01 N, R27 E, BLOCK 2, Lot 2, 20368 SQ FT	(07)
67	C15526	\$	150.00	KENMARK CORPORATION	3395 LA PAZ DR	SIERRA ESTATES SUB 3RD FIL, S29, T01 N, R27 E, BLOCK 2, Lot 3, 20368 SQ FT	(07)
68	C15527	\$	150.00	HEINE, TYLER JAMES & CHELSEA LARAE	3385 LA PAZ DR	SIERRA ESTATES SUB 3RD FIL, S29, T01 N, R27 E, BLOCK 2, Lot 4, 26003 SQ FT	(07)
69	C15528	\$	150.00	BAASCH, BRIAN E & LOREE M	3375 LA PAZ DR	SIERRA ESTATES SUB 3RD FIL, S29, T01 N, R27 E, BLOCK 2, Lot 5, 23734 SQ FT	(07)
70	C15529	\$	150.00	ANDERSON, RYAN W & LESLIE K	3365 LA PAZ DR	SIERRA ESTATES SUB 3RD FIL, S29, T01 N, R27 E, BLOCK 2, Lot 6, 23734 SQ FT	(07)
71	C15530	\$	150.00	SCHMITT, CASEY & KALLY J	3355 LA PAZ DR	SIERRA ESTATES SUB 3RD FIL, S29, T01 N, R27 E, BLOCK 2, Lot 7, 23907 SQ FT	(07)
72	C15531	\$	150.00	GAGNON, TAMARA R	3345 LA PAZ DR	SIERRA ESTATES SUB 3RD FIL, S29, T01 N, R27 E, BLOCK 2, Lot 8, 23963 SQ FT	(07)
73	C15532	\$	150.00	NEUGEBAUER, COLE M & KATRINA F	3335 LA PAZ DR	SIERRA ESTATES SUB 3RD FIL, S29, T01 N, R27 E, BLOCK 2, Lot 9, 28680 SQ FT	(07)
74	C15533	\$	150.00	LAWRENCE, CHAD S & AMANDA L	3315 LA PAZ DR	SIERRA ESTATES SUB 3RD FIL, S29, T01 N, R27 E, BLOCK 2, Lot 10, 20140 SQ FT	(0*
75	C15534	\$	150.00	LAYA, TAMMIE & RENE	3285 LA PAZ DR	SIERRA ESTATES SUB 3RD FIL, S29, T01 N, R27 E, BLOCK 2, Lot 11, 20023 SQ FT	(0*
76	C15535	\$	150.00	INHOFFER, RAYMOND P & SHIRLEY K		SIERRA ESTATES SUB 3RD FIL, S29, T01 N, R27 E, BLOCK 2, Lot 12, 20779 SQ FT	(0*
77	C15536	\$	150.00	INHOFFER, RAYMOND P & SHIRLEY K		SIERRA ESTATES SUB 3RD FIL, S29, T01 N, R27 E, BLOCK 2, Lot 13, 20779 SQ FT	(0*
78	C15537	\$	150.00	MICHALIES, JESSE G		SIERRA ESTATES SUB 3RD FIL, S29, T01 N, R27 E, BLOCK 2, Lot 14, 20023 SQ FT	(0*
79	C15538	\$	150.00	LONG, ZACHERY J & SHANNON M		SIERRA ESTATES SUB 3RD FIL, S29, T01 N, R27 E, BLOCK 2, Lot 15, 20370 SQ FT	(0*
80	C15539	\$	150.00	FRANK, CASEY & BARBARA		SIERRA ESTATES SUB 3RD FIL, S29, T01 N, R27 E, BLOCK 2, Lot 16, 22747 SQ FT	(0*
81	C15540	\$	150.00	NAGEL, MYRON K & CHERYL A		SIERRA ESTATES SUB 3RD FIL, S29, T01 N, R27 E, BLOCK 2, Lot 17, 24387 SQUARE FE*	(0*
82	C15541	\$	150.00	MURRAY, SHAWN C & KAREN J		SIERRA ESTATES SUB 3RD FIL, S29, T01 N, R27 E, BLOCK 2, Lot 18, 44397 SQ FT	(0*
83	C15542	\$	150.00	KENNEDY, DAVID T & LISA A		SIERRA ESTATES SUB 3RD FIL, S29, T01 N, R27 E, BLOCK 2, Lot 19, 43305 SQ FT	(0*
84	C15544	\$	150.00	WEATHERWAX, WILLIAM J &		SIERRA ESTATES SUB 3RD FIL, S29, T01 N, R27 E, BLOCK 2, Lot 20, 20104 SQ FT	(07)
85	C15545	\$	150.00	MONTEZ, ROBERT G		SIERRA ESTATES SUB 3RD FIL, S29, T01 N, R27 E, BLOCK 3, Lot 1, 20088 SQ FT	(07)
86	C15546	\$	150.00	LEWIS, STEPHEN P & TARA		SIERRA ESTATES SUB 3RD FIL, S29, T01 N, R27 E, BLOCK 3, Lot 2, 20088 SQ FT	(07)
87	C15547	\$	150.00	OLISZCZAK, TOBY M & RENEE L		SIERRA ESTATES SUB 3RD FIL, S29, T01 N, R27 E, BLOCK 3, Lot 3, 20088 SQ FT	(07)
88	C15548	\$	150.00	RANDALL, WILLIAM L & PAMELA E		SIERRA ESTATES SUB 3RD FIL, S29, T01 N, R27 E, BLOCK 3, Lot 4, 20186 SQ FT	(0*
89	C15549	\$	150.00	WEIMER, DANIEL R		SIERRA ESTATES SUB 3RD FIL, S29, T01 N, R27 E, BLOCK 3, Lot 5, 23045 SQ FT	(07)
90	C15550	\$	150.00	LACK, LYLE R & SHANNON L		SIERRA ESTATES SUB 3RD FIL, S29, T01 N, R27 E, BLOCK 3, Lot 6, 22676 SQ FT	(0*
91	C15551	\$	150.00	AAFEDT, SHAWN & JEANETTE		SIERRA ESTATES SUB 3RD FIL, S29, T01 N, R27 E, BLOCK 3, Lot 7, 26878 SQ FT	(0*
92	C15552	\$	150.00	WESSEL, FRED & KANDIS		SIERRA ESTATES SUB 3RD FIL, S29, T01 N, R27 E, BLOCK 3, Lot 8, 21210 SQ FT	(0*
93	C15553	\$	150.00	PARISIAN, EDWARD F & BARBARA J		SIERRA ESTATES SUB 3RD FIL, S29, T01 N, R27 E, BLOCK 3, Lot 9, 20433 SQ FT	(0*
94	C15554	\$	150.00	OSBORNE, LEVI & KRISTA		SIERRA ESTATES SUB 3RD FIL, S29, T01 N, R27 E, BLOCK 3, Lot 10, 20092 SQ FT	(0*
95	C15555	\$	150.00	WILLIAMS, WESLEY WOODRUFF & KRISTA MARIE		SIERRA ESTATES SUB 3RD FIL, S29, T01 N, R27 E, BLOCK 3, Lot 11, 20388 SQ FT	(0*
96	C15556	\$	150.00	SOAPES, WAYNE F & MICHELLE R		SIERRA ESTATES SUB 3RD FIL, S29, T01 N, R27 E, BLOCK 3, Lot 12, 20388 SQ FT	(0*
97	C15558	\$	150.00	BROWN, JERRY D		SIERRA ESTATES SUB 3RD FIL, S29, T01 N, R27 E, BLOCK 3, Lot 13, 20104 SQ FT	(0*
98	C15559	\$	150.00	LIGHT, CHRISTOPHER & JESSICA		SIERRA ESTATES SUB 3RD FIL, S29, T01 N, R27 E, BLOCK 4, Lot 1, 22947 SQ FT	(0*
99	C15560	\$	150.00	KOBER, KEITH E & CYNTHIA D		SIERRA ESTATES SUB 3RD FIL, S29, T01 N, R27 E, BLOCK 4, Lot 2, 22970 SQ FT	(0*
100	C15561	\$	150.00	WEBER, JERRY A		SIERRA ESTATES SUB 3RD FIL, S29, T01 N, R27 E, BLOCK 4, Lot 3, 20819 SQ FT	(07)
101	C15562	\$	150.00	WATTS, JOSHUA GLEN & HEATHER		SIERRA ESTATES SUB 3RD FIL, S29, T01 N, R27 E, BLOCK 4, Lot 4, 25146 SQ FT	(07)
102	C15563	\$	150.00	OLSON, DARRIN W & STEPHANNI		SIERRA ESTATES SUB 3RD FIL, S29, T01 N, R27 E, BLOCK 4, Lot 5, 38292 SQ FT	(07)
103	C15564	\$	150.00	HOERSTER, RYAN ALLEN		SIERRA ESTATES SUB 3RD FIL, S29, T01 N, R27 E, BLOCK 4, Lot 6, 21684 SQ FT	(0*
104	C15566	\$	150.00	KENMARK CORPORATION		SIERRA ESTATES SUB 3RD FIL, S29, T01 N, R27 E, BLOCK 5, Lot 1, 20313 SQ FT	(0*
105	C15567	\$	150.00	KENMARK CORPORATION		SIERRA ESTATES SUB 3RD FIL, S29, T01 N, R27 E, BLOCK 5, Lot 2, 27066 SQ FT	(07)
106	C15568	\$	150.00	KENMARK CORPORATION		SIERRA ESTATES SUB 3RD FIL, S29, T01 N, R27 E, BLOCK 5, Lot 3, 42657 SQ FT	(07)
107	C15569	\$	150.00	KENMARK CORPORATION		SIERRA ESTATES SUB 3RD FIL, S29, T01 N, R27 E, BLOCK 5, Lot 4, 51636 SQ FT	(0*
108	C15570	\$	150.00	KENMARK CORPORATION		SIERRA ESTATES SUB 3RD FIL, S29, T01 N, R27 E, BLOCK 5, Lot 5, 49805 SQ FT	(0*
109	C15571	\$	150.00	KENMARK CORPORATION		SIERRA ESTATES SUB 3RD FIL, S29, T01 N, R27 E, BLOCK 5, Lot 6, 21026 SQ FT	(07)
110	C15572	\$	150.00	KENMARK CORPORATION		SIERRA ESTATES SUB 3RD FIL, S29, T01 N, R27 E, BLOCK 5, Lot 7, 21863 SQ FT	(07)
111	C15573	\$	150.00	KENMARK CORPORATION		SIERRA ESTATES SUB 3RD FIL, S29, T01 N, R27 E, BLOCK 5, Lot 8, 21863 SQ FT	(07)

EXHIBIT B
 RSID 698M SIERRA ESTATES SUB - 2ND FILING

2016 EXPANSION	
112 C15574	\$ 150.00 KENMARK CORPORATION
113 C15575	\$ 150.00 KENMARK CORPORATION
114 C15576	\$ 150.00 KENMARK CORPORATION
115 C15577	\$ 150.00 KENMARK CORPORATION
116 C15578	\$ 150.00 KENMARK CORPORATION
117 C15579	\$ 150.00 KENMARK CORPORATION
118 C15580	\$ 150.00 KELLER, JEFFERY & LAURENA
119 C15581	\$ 150.00 CAVAZOS, JEFF R & ROYCE ANN
120 C15582	\$ 150.00 OLSEN, MARK J
121 C15583	\$ 150.00 KENMARK CORPORATION
122 C15584	\$ 150.00 KENMARK CORPORATION
123 C15585	\$ 150.00 KENMARK CORPORATION
124 C15586	\$ 150.00 ARNESON, ALEXANDER L & JESSICA L
125 C15587	\$ 150.00 VALANDRA, CLINTON & MARIA
126 C15588	\$ 150.00 IRON SHIRT, MELVIN K & SAMANTHA L
127 C15589	\$ 150.00 MARVIN, JOHN & MICHELE
128 C16626	\$ 150.00 KLINER, NANCY A
129 C16627	\$ 150.00 CASEY, SHERYL L
130 C16628	\$ 150.00 PHILYAW, CHRISOPHER PAUL
131 C16629	\$ 150.00 CRANE, BRANDON M & HEIDI L
132 C16630	\$ 150.00 MATTILLA, DIANNE M
133 C16631	\$ 150.00 REDDEN, MAVIS A & BUD G
134 C16632	\$ 150.00 SWANSON, CHARLES E & VALERIE R
135 C16633	\$ 150.00 STORY, LANCE W & PATRICIA
	<u>\$ 20,250.00</u>

Parcels to include in expansion:

136 C11108	\$ 150.00 MEIER, ANDREW M & NORA
137 C16634	\$ 150.00 SUPERIOR BUILDERS LLP

\$ 20,550.00 New District Total

3300 NAVARRO DR	SIERRA ESTATES SUB 3RD FIL, S29, T01 N, R27 E, BLOCK 5, Lot 9, 29241 SQ FT (*)
3280 NAVARRO DR	SIERRA ESTATES SUB 3RD FIL, S29, T01 N, R27 E, BLOCK 5, Lot 10, 35381 SQ FT (*)
3285 NAVARRO DR	SIERRA ESTATES SUB 3RD FIL, S29, T01 N, R27 E, BLOCK 5, Lot 11, 23719 SQ FT (*)
3305 NAVARRO DR	SIERRA ESTATES SUB 3RD FIL, S29, T01 N, R27 E, BLOCK 5, Lot 12, 24065 SQ FT (*)
3335 NAVARRO DR	SIERRA ESTATES SUB 3RD FIL, S29, T01 N, R27 E, BLOCK 5, Lot 13, 24069 SQ FT (*)
3360 HIDALGO DR	SIERRA ESTATES SUB 3RD FIL, S29, T01 N, R27 E, BLOCK 5, Lot 14, 24069 SQ FT (*)
3340 HIDALGO DR	SIERRA ESTATES SUB 3RD FIL, S29, T01 N, R27 E, BLOCK 5, Lot 15, 22414 SQ FT (*)
3320 HIDALGO DR	SIERRA ESTATES SUB 3RD FIL, S29, T01 N, R27 E, BLOCK 5, Lot 16, 22432 SQ FT (*)
3300 HIDALGO DR	SIERRA ESTATES SUB 3RD FIL, S29, T01 N, R27 E, BLOCK 5, Lot 17, 22629 SQ FT (*)
3270 HIDALGO DR	SIERRA ESTATES SUB 3RD FIL, S29, T01 N, R27 E, BLOCK 5, Lot 18, 20655 SQ FT (0*)
3250 HIDALGO DR	SIERRA ESTATES SUB 3RD FIL, S29, T01 N, R27 E, BLOCK 5, Lot 19, 20643 SQ FT (*)
3220 HIDALGO DR	SIERRA ESTATES SUB 3RD FIL, S29, T01 N, R27 E, BLOCK 5, Lot 20, 28232 SQ FT (*)
225 TOLEDO ST	SIERRA ESTATES SUB 3RD FIL, S29, T01 N, R27 E, BLOCK 5, Lot 21, 28322 SQ FT (0*)
215 TOLEDO ST	SIERRA ESTATES SUB 3RD FIL, S29, T01 N, R27 E, BLOCK 5, Lot 22, 30620 SQ FT (*)
205 TOLEDO ST	SIERRA ESTATES SUB 3RD FIL, S29, T01 N, R27 E, BLOCK 5, Lot 23, 40746 SQ FT (*)
3405 SAN MARINO DR	SIERRA ESTATES SUB 3RD FIL, S29, T01 N, R27 E, BLOCK 5, Lot 24, 20672 SQ FT (07)
3408 SAN MARINO DR	ASPEN RIDGE SUB 1ST FILING (11), S29, T01 N, R27 E, BLOCK 1, Lot 1, (OLD #D66557)
3413 SAN MARINO DR	ASPEN RIDGE SUB 1ST FILING (11), S29, T01 N, R27 E, BLOCK 1, Lot 2, (OLD #D66557)
3421 SAN MARINO DR	ASPEN RIDGE SUB 1ST FILING (11), S29, T01 N, R27 E, BLOCK 1, Lot 3, (OLD #D66557)
3408 SAN MARINO DR	ASPEN RIDGE SUB 1ST FILING (11), S29, T01 N, R27 E, BLOCK 2, Lot 1, (OLD #D66557)
3412 SAN MARINO DR	ASPEN RIDGE SUB 1ST FILING (11), S29, T01 N, R27 E, BLOCK 3, Lot 1, (OLD #D66557)
3416 SAN MARINO DR	ASPEN RIDGE SUB 1ST FILING (11), S29, T01 N, R27 E, BLOCK 3, Lot 2, (OLD #D66557)
3420 SAN MARINO DR	ASPEN RIDGE SUB 1ST FILING (11), S29, T01 N, R27 E, BLOCK 3, Lot 3, (OLD #D66557)

500 EL PASO ST	SIERRA ESTATES SUBD 1ST FILING, S30, T01 N, R27 E, BLOCK 4, Lot 12
832 GRANITE ESTATES LN	ASPEN RIDGE SUB 1ST FILING (11), S29, T01 N, R27 E, BLOCK 3, Lot 5, (OLD #D66557)